



Specifications

Contact Rating: 0.4 VA max.@ 20 VAC or DC.
 Mechanical and Electrical Life: 100,000 actuations min. at full load.
 Contact Resistance: 200 mΩ max. (initial value) @ 2-4 VDC, 100 mA.
 Note: When the switches with the wire assembly, we only test the electric conduction and will not test the contact resistance on the wire.
 Insulation Resistance: 100 MΩ min. at 1,000 VDC
 Dielectric Strength: 500 Vrms min. @sea level (initial value).
 Operating Temperature: -30°C to 85°C.

Ingree Protection:



Materials

Housing: Nylon 6/6 (UL 94 V-0)
 Actuator: Nylon 6/6 (UL 94 V-0)
 Movable Contact: Phosphor bronze, gold plated over nickel plated.
 Fixed Contact: Brass, gold plated over nickel plated.
 Wire: UL 10602-24 AWG.

HOW TO ORDER



Model No.	Actuator	Function	Wire Length	Heat Shrink Tube	Housing	Jump
PS92	1 10.40 mm, Flat 2 10.00 mm, Round 3 9.50 mm, Flat	2 ON - (OFF)	120 120 mm (Std.) 150 150 mm 250 250 mm 300 300 mm 400 400 mm 500 500 mm XXX Other Wire Lengths	0 No 1 Yes	0 No 1 2P 2 2P Lock 3 3P 4 3P Lock	0 No 1 1 - 3 2 2 - 3 3 1 - 2

Note: Please consult sales for additional wire options.

EXAMPLE:

PS9222-1200-00 (No Housing)

▼ SWITCH FUNCTION AND PANEL CUTOUT

Model No.	POS. 1	POS. 2
		
PS92	ON	(OFF)
Schematic		

()=Momentary

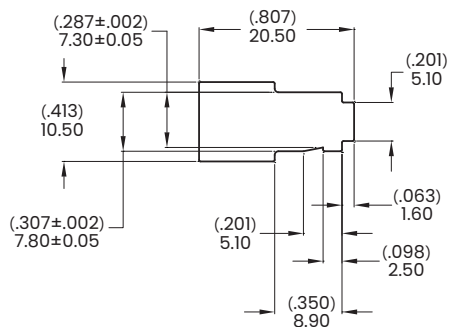

Panel thickness: 1 mm (.039 inch) max.

PS9
Pushbutton Switches

▼ DIMENSION

