



Specifications

Max. current/voltage rating with resistive load:
5A 28VDC , 25,000 cycles
Initial Contact Resistance: 50 mΩ max.
Insulation Resistance: 1 GΩ min. at 500 VDC.
Dielectric Strength: 1,000 VAC rms.
Total Travel: 1.8 mm.
Operating Force: 8N±2N.
Mechanical Life: 1,000,000 cycles.
Torque: 0.5 Nm max. applied to nut.
Operating Temperature: -40°C to 85°C.

Ingree Protection: IP68 (In house test)  

Soldering Process

Manual Soldering: Use 60 watts soldering iron and controlled the temperature at 280°. Duration of solder immersion: Max. 3 sec.

Materials

Cap: PC.
Plunger: Polyamide 6/6.
Rubber: Silicone.
Bushing: Polyamide 6/6.
Case: Polyamide 6/6.
Terminals: Brass, Gold over silver plated.
Contact: Brass, Gold over silver plated.

IP 68 for the whole series:

Protected against the effects of immersion up to 1 m water (60 min)

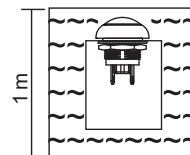

HOW TO ORDER

Note: Specifications and availability subject to change without notice.

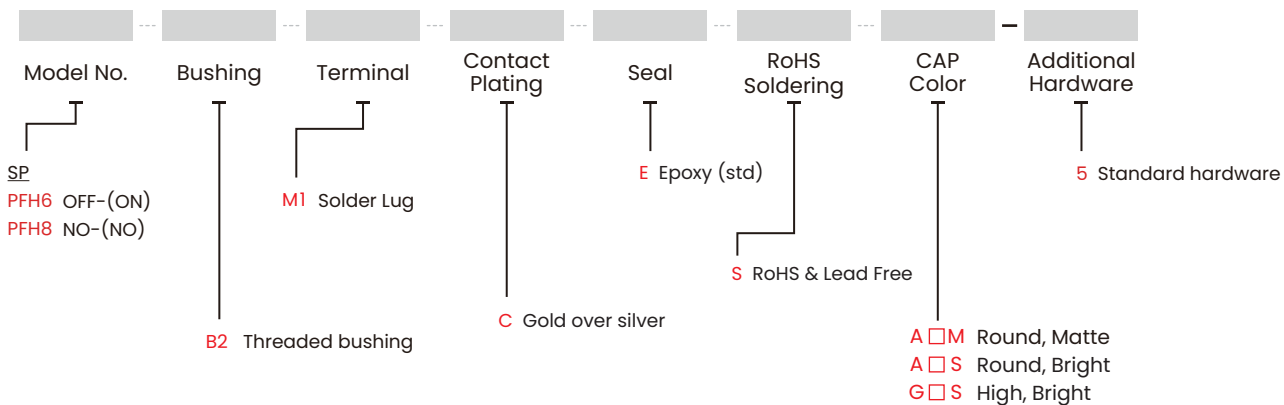

CAP Color	Item No.		
	Round		High
White	A1M	A1S	G1S
Black (Std)	A2M	A2S	G2S
Red (Std)	A3M	A3S	G3S
Orange	A4M	A4S	G4S
Yellow	A5M	A5S	G5S
Green	A6M	A6S	G6S
Blue	A7M	A7S	G7S

Note: For other colors information please consult sales representative.

EXAMPLE:
PFH6B2M1CES □ -5
Cap type



▼ SWITCH FUNCTION

PFH
Pushbutton Switches

No. Poles	Model No.	Switch Function		Connected Terminals / Schematic	
		POS. 1	POS. 2	POS. 1	POS. 2
SP	PFH6	OFF	(ON)	OPEN	CLOSE
	PFH8	ON	(ON)	OPEN	CLOSE

()=Momentary

▼ CAP OPTIONS

Round

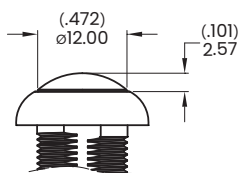

High

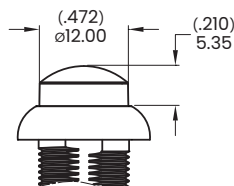

▼ DIMENSION

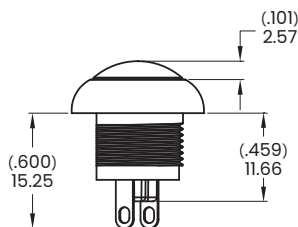
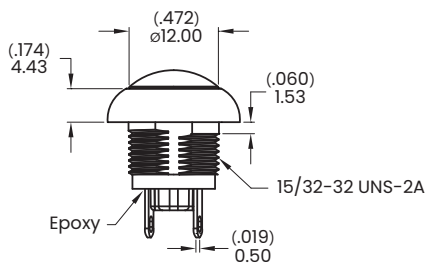
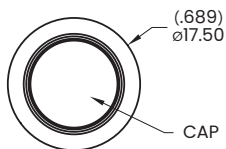

SPST

Model name. PFH6B2MICESA3S-5

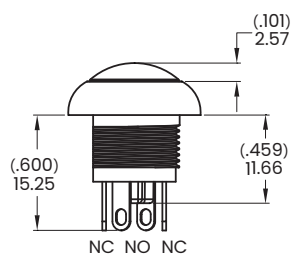
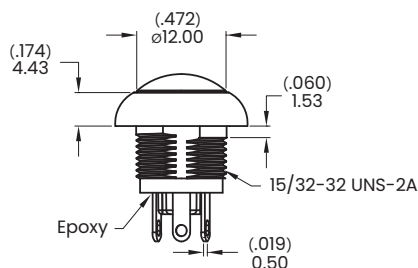
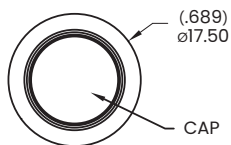

SPDT

Model name. PFH8B2MICESA4S-5



▼ **PANEL MOUNTING**

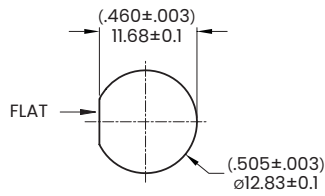

Panel thickness:
0.6 mm (.024 inch) min. ~ 3.0 mm (.118 inch) max.

▼ **HARDWARE**

- * Standard for threaded bushing : 1 Nut, 1 O-Ring, 1 Lock Washer
- * For further information please consult sales representative.

Hex Nut

Model name. MNU-1M07

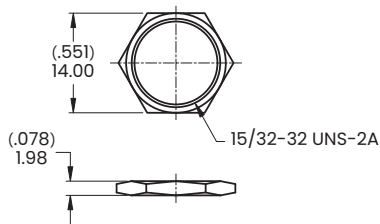

Lock Washer

Model name. MNU-1M09

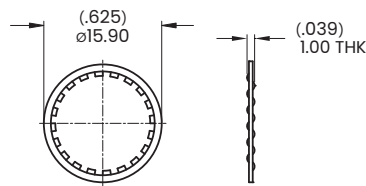

O-Ring

Model name. VRG-S105129-120BK-1

