



Specifications

Pole-Position: Momentary type, SPST with LED.
 Contact Rating: 30V DC, 0.1A.
 Contact Resistance: 50 mΩ max. 1.5V DC ; 100 mA, by method of voltage DROP.
 Insulation Resistance: 100 MΩ min. at 500V DC.
 Dielectric Strength: 500V AC for 1 minute (initial value).
 Operating Force: 250 ± 100 gf.
 Operating Life: 50,000 cycles.
 Operating Temperature Range: -40°C to 85°C.
 Total Travel: 1.2 ± 0.3 mm.

Materials

Cap : PC.
 Case & Housing : Nylon 6/6.
 Terminal : Copper with gold plated.

Soldering Process

Manual Soldering: Soldering Temperature : 350±5°C.
 Duration of solder immersion: Max. 5 sec.

Ingree Protection:



HOW TO ORDER

Note: Specifications and availability subject to change without notice.

Model No.	Led Type																				
PBL	A0 Translucent CAP, No LED A2 Black CAP, No LED																				
	With LED:																				
	<table border="1"> <thead> <tr> <th>Item No.</th> <th>Color</th> </tr> </thead> <tbody> <tr> <td colspan="2">Single Color LED</td> </tr> <tr> <td>01</td> <td>White</td> </tr> <tr> <td>03</td> <td>Red</td> </tr> <tr> <td>05</td> <td>Yellow</td> </tr> <tr> <td>06</td> <td>Green</td> </tr> <tr> <td>07</td> <td>Blue</td> </tr> <tr> <td colspan="2">Dual Color LED</td> </tr> <tr> <td>36</td> <td>Red+Green</td> </tr> <tr> <td>76</td> <td>Blue+Green</td> </tr> </tbody> </table>	Item No.	Color	Single Color LED		01	White	03	Red	05	Yellow	06	Green	07	Blue	Dual Color LED		36	Red+Green	76	Blue+Green
Item No.	Color																				
Single Color LED																					
01	White																				
03	Red																				
05	Yellow																				
06	Green																				
07	Blue																				
Dual Color LED																					
36	Red+Green																				
76	Blue+Green																				

EXAMPLE:
 PBL-A2 (Without LED)
 PBL-□ (With LED)
 LED color

Circuit Diagram

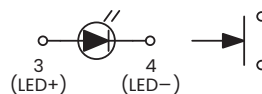

Single LED

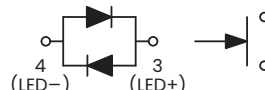

Dual colors LED

Note: For other colors information please consult sales representative.

▼ DIMENSION

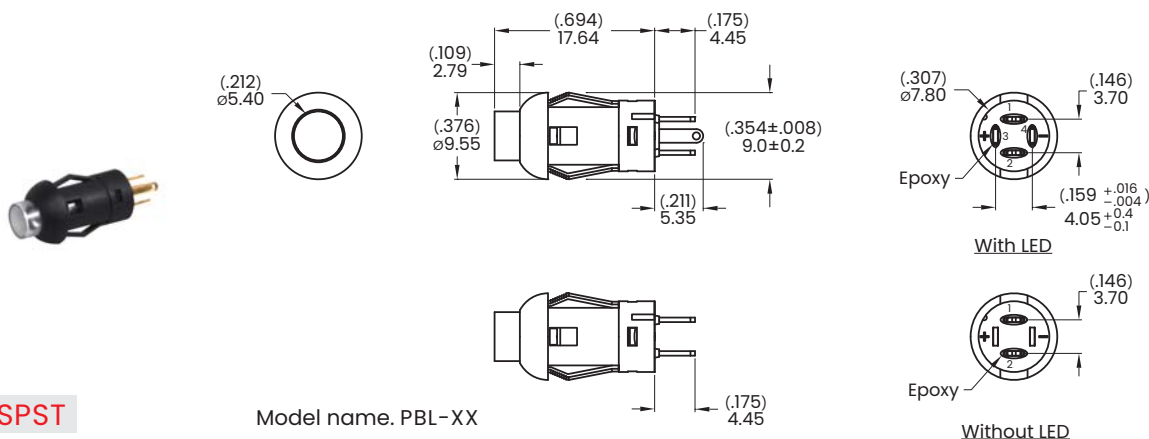

SPST

Model name. PBL-XX

▼ PANEL and PCB MOUNTING

Panel Mounting

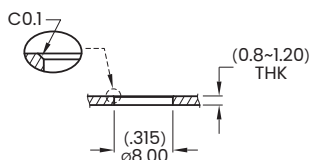

PCB Mounting

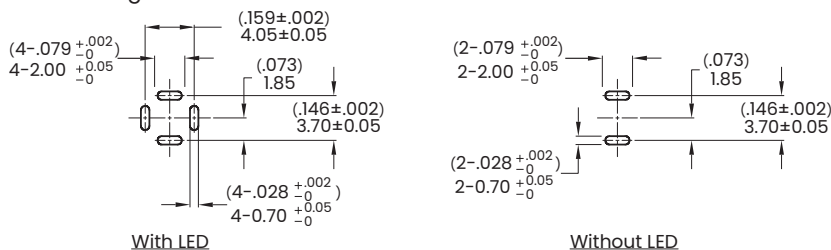

Specifications

Function: Momentary action.
 Mechanical Life: 100,000 make-and-break cycles.
 Electrical Life: 50,000 cycles.
 Contact Resistance: 200 mΩ max. (initial value) @ 2-4 VDC 100 mA
 Contact Rating: 0.4 Volt-Amps (VA) max.@20V max (AC or DC)
 Operating Position: 0.65 ± 0.2 mm.
 Operating Force: 450 ± 130 gf.
 Insulation Resistance: 100 MΩ min.
 Dielectric Strength: 1,000 V RMS @sea level.(initial value)
 Operating Temperature: -30°C to 85°C.
 Torque: 2.2 Nm max. applied to nut.

Ingress Protection: IP67 (In house test)



Materials

Housing & Bushing: Nylon 6/6.
 Button: Stainless steel.
 Actuator: Silicon.
 Conductive Contact: Stainless Steel with gold plated.
 Terminal: Copper alloy ,with gold plated.

Soldering Process

Manual Soldering: Soldering Temperature : 350±5°C.
 Duration of solder immersion: Max. 5 sec.

HOW TO ORDER

Model No.	Force	Housing	Housing Size	Bushing	Cover	Terminal	Contact Plating	Additional Hardware
PY OFF-ON	A45 450±130 gf	S Square	20 20mm	11 11mm	X0 NO	M1 Solder Lug	R Gold	O1 Standard hardware

▼ DIMENSION

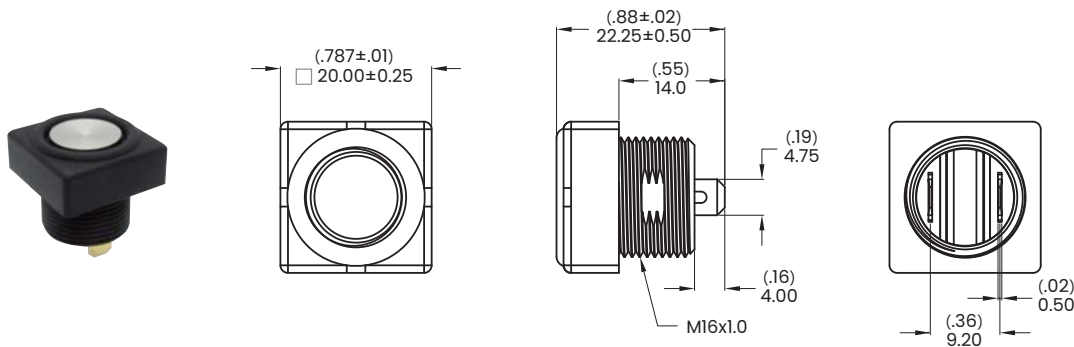

Model name: PYA45S2011X0M1R01

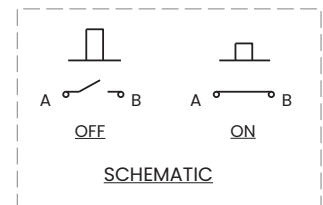

▼ PANEL MOUNTING & HARDWARE

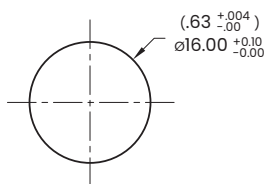

Panel thickness:
 1.5 mm (.059 inch) min. ~5 mm (.197 inch) max.

* Standard hardware : 1 Nut, 1 O-Ring
 * For further information please consult sales representative.

O-Ring
 Model name. FCP-PY02

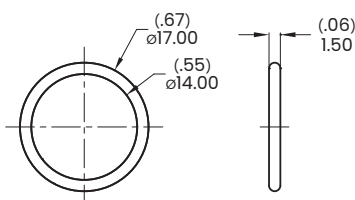

Hex Nut
 Model name. MNU-PY01

