

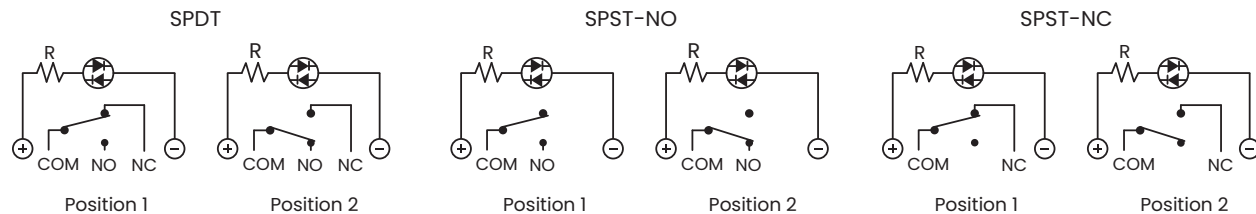

▼ **CIRCUIT**



▼ **BODY OPTIONS**

A0 / C3

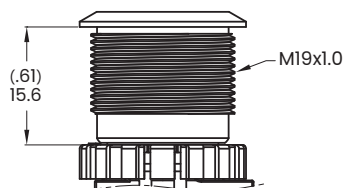

Panel Mounting

Max. Panel thickness: 10.0 mm (.394 inch)

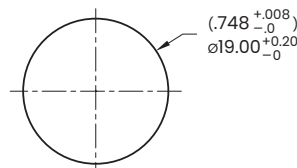

▼ **BUTTON OPTIONS**

F Flat (Std.)

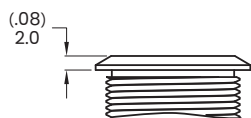

H High, No LED

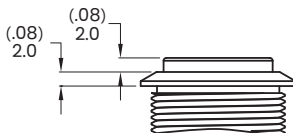

R Round, No LED

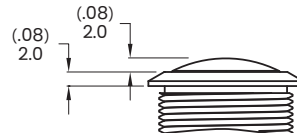

Note: Options H and R are only available with stainless steel body.

▼ **LIGHT OPTIONS**

O Without LED

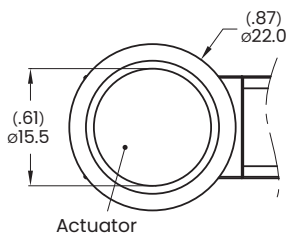

E Ring Moveable

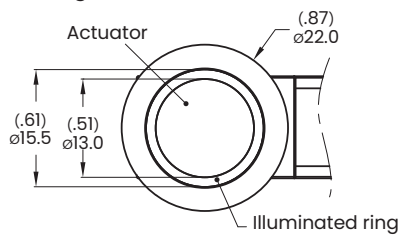

D Spot

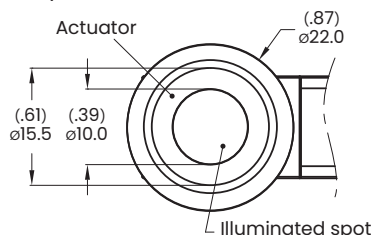

Note: Available with flat button only.

P Power logo

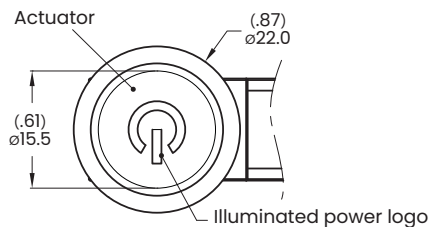

L Ring+Power logo

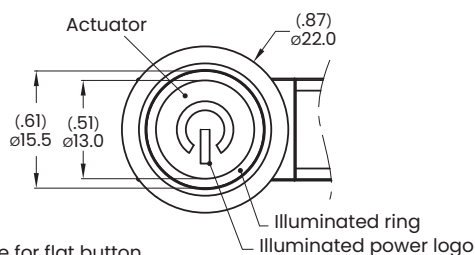

Note: Options P and L are only available for flat button.

▼ **TERMINAL OPTIONS**

#187 Only 16A

Quick-connect terminal
(t = 0.8 mm (0.3 inch))

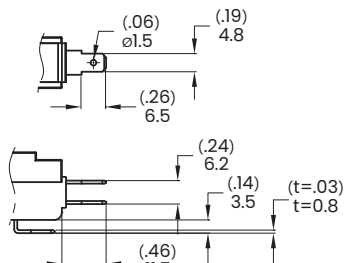

#250 Only 26A

Quick-connect terminal
(t = 0.8 mm (0.3 inch))

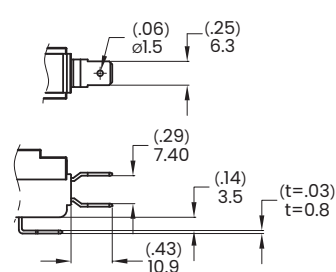



▼ DIMENSION

16A

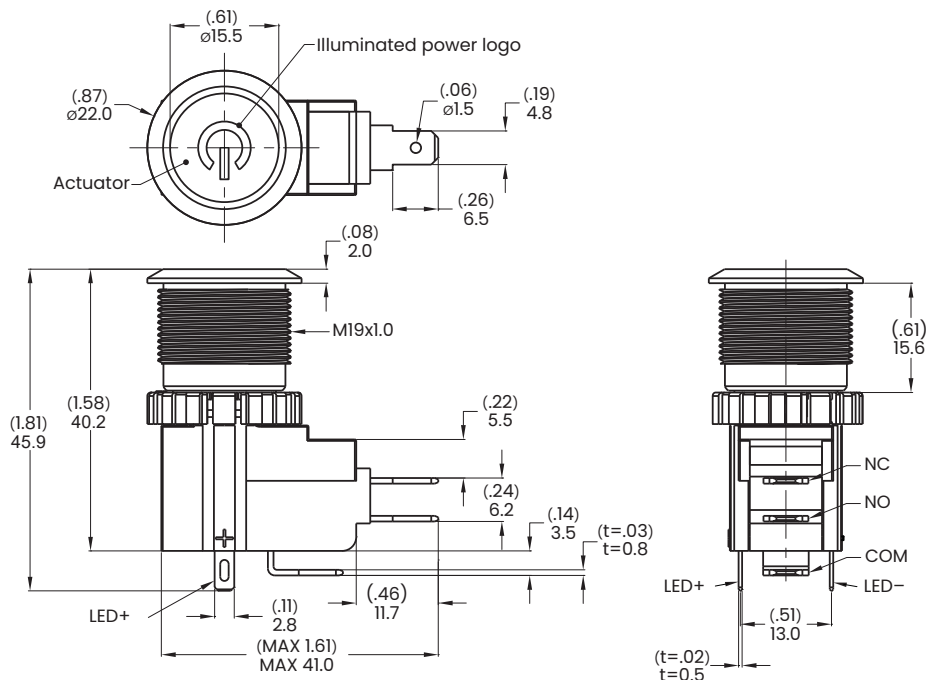

SPDT

Model name. MW19-A0F0P312-A1ZB

26A

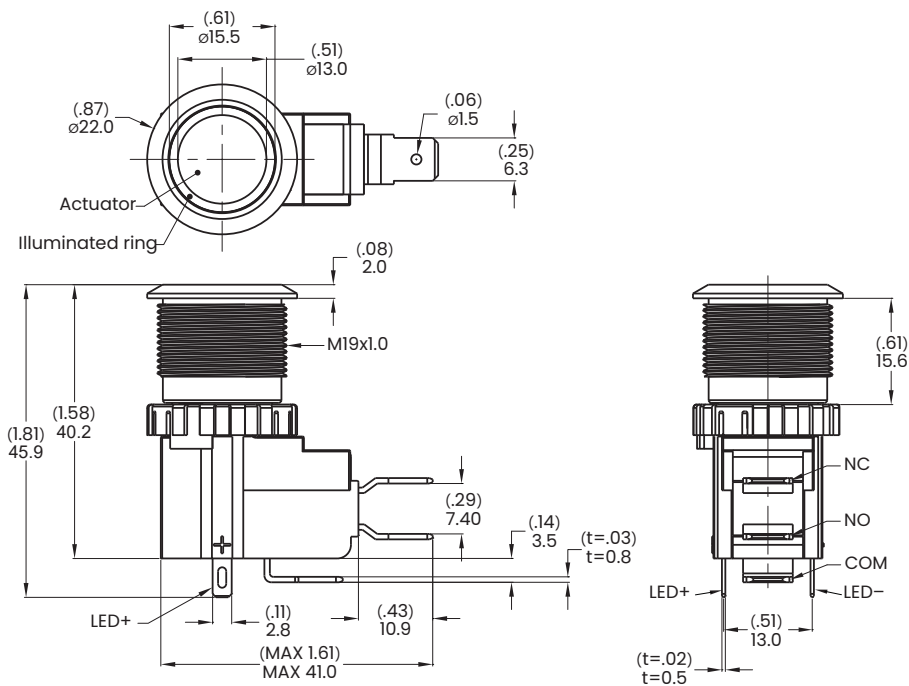

SPDT

Model name. MW19-A0F0E112-A3ZA

▼ HARDWARE

* Standard hardware : 1 Nut, 1 O-Ring. * For further information please consult sales representative.

O-Ring

Model name. FCP-PY02

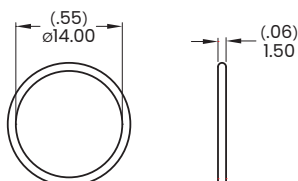

Hex Nut

Model name. MNU-MPB01

